

## NOTES

### DECK 1

Administrative Offices are for resolving passenger issues are at the front.

Equipment for connecting to the PTOLEMY-Class ship's docking collar is located in four rooms. This equipment continues downwards to Deck 2.

There is a Piping / Wiring Trunk connection point about one-third of the distance from the front. From that point to the rear turbo-elevator, the ceiling of the park continues to the top of the hull of the container. The trees in the Park takes advantage of this high ceiling.

Refreshment centers separate the Park from the Pool. The Pool is located at the extreme aft.

### DECK 2

The upper level of the Main Lounge is located at the front of this deck. The floor in the center is open to allow patrons to see the dance floor below.

Aft of the Lounge (and to port) is the park. To starboard is the shopping district.

Further aft are Virtual Reality / Holodecks. The technology is new and not always available. These were originally called "VisiCon" by Franz Joseph.

The Coffee Bar and Lobby lead to the Live Theater/Stage to port and the Movie Screen to starboard. Each can hold about 200 people. The floor is sloped for better visibility.

At the extreme aft are Batteries, the Brig, and the bottom of the Pool.

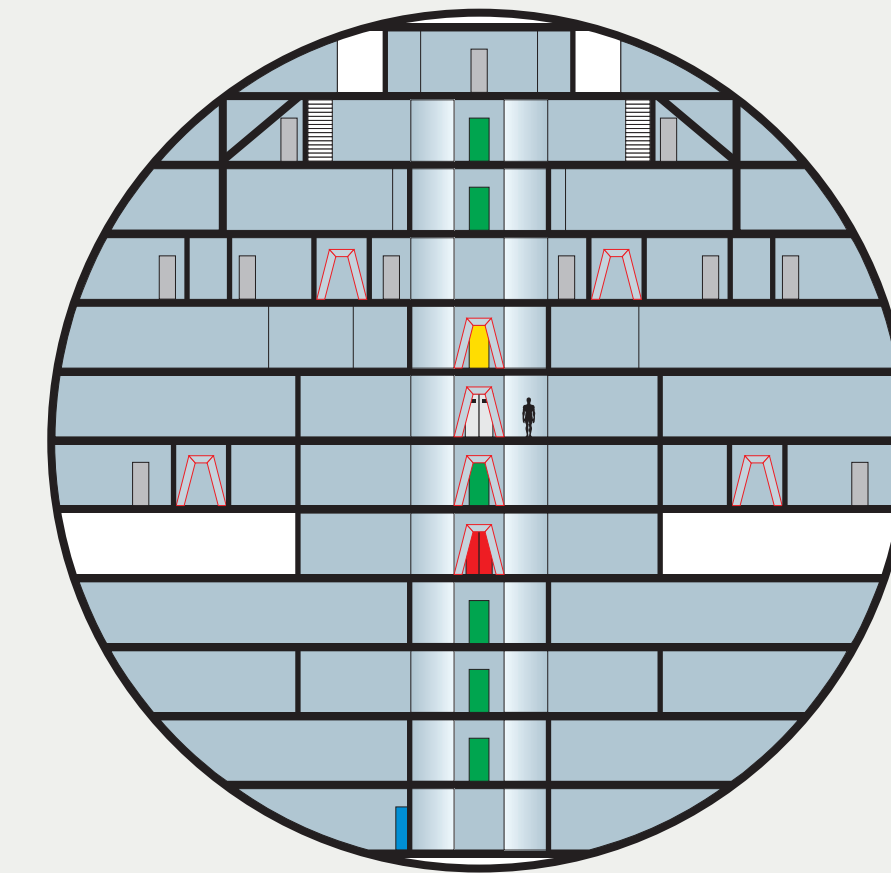

CROSS-SECTION A-A

## DECK 1: OFFICES / PARK / POOL

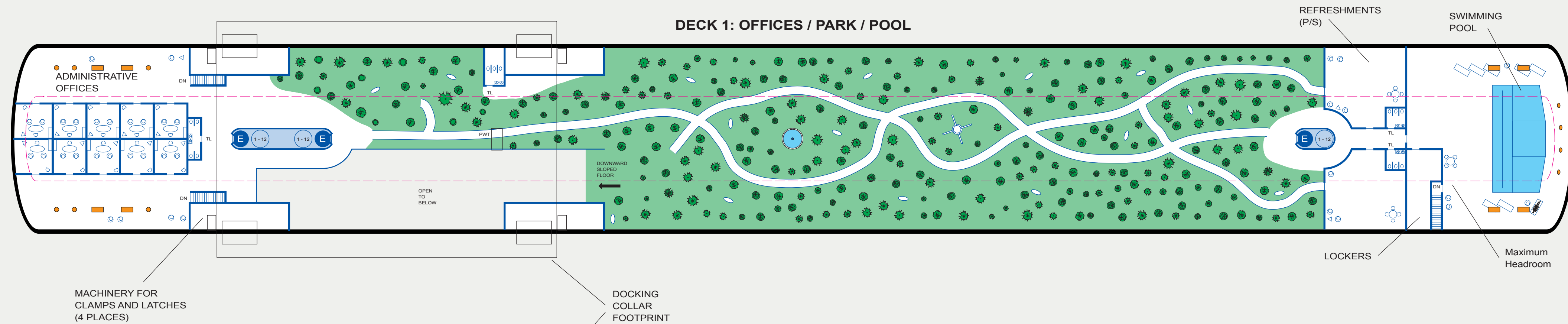

## DECK 2: LOUNGE / ENTERTAINMENT / BRIG

