

If printed 17 inches tall (from black-outlined edge to black-outlined edge) the scale of these drawings is 1/350.

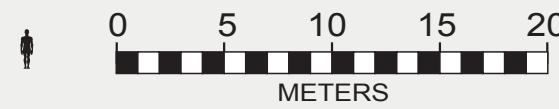

THE DESILU STAGE AT THE SAME SCALE

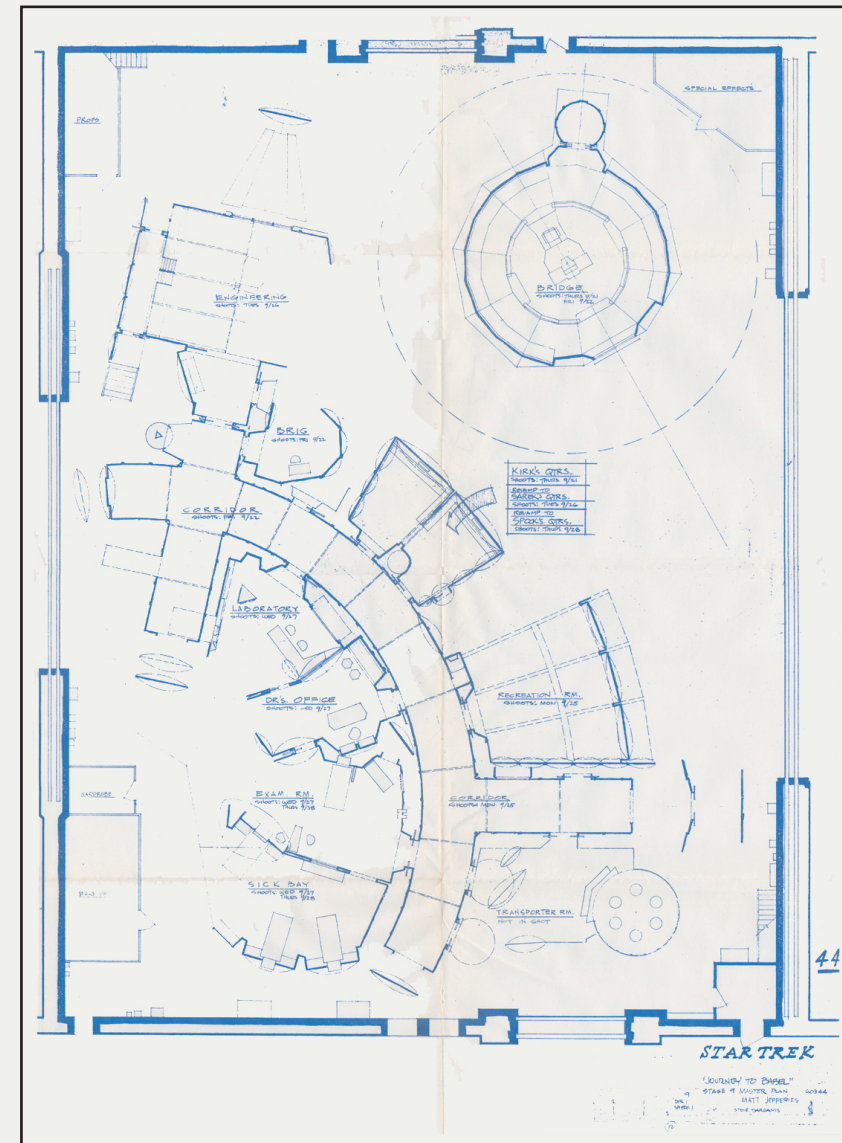

CUTAWAY SYMBOLS

- STRAIGHT WALL
- CURVED WALL
- CUTAWAY ALONG WALL
- INNER FACE OF HULL
- CUTAWAY THROUGH DECK
- CUTAWAY ACROSS WALL
- CUTAWAY THROUGH DOOR
- DOORS
- ISOLATION DOORS
- PRIVACY SCREENS
- RECTANGULAR LADDER ALCOVE
- ROUND LADDER ALCOVE
- STAIRS
- RAILING
- TREE, SHRUB

ABBREVIATIONS

- AA - ACTOR'S AREA
- AM - AUXILIARY MACHINERY
- BL - BIO LAB
- C - CORRIDOR
- CE - CHIEF ENGINEER
- CMO - CHIEF MEDICAL OFFICER
- CN - CHIEF NURSE
- CNO - CHIEF NAVIGATOR'S OFFICE
- CO - COMMANDING OFFICER
- COO - COMMUNICATIONS OFFICER'S OFFICE
- CON - CONVALESCENT WARD
- CW - COLLAPSIBLE WALLS
- DC - DECOMPRESSION CHAMBER
- DN - DOWN
- DO - DENTAL OFFICE
- E - TURBO-ELEVATOR CAR
- EE - ENVIRONMENTAL ENGINEERING
- EL - ENVIRONMENTAL SUIT LOCKER
- EM - TURBO-ELEVATOR MAINTENANCE
- EMS - ENGINEERING MACHINE SHOPS
- EO - CHIEF ENGINEER'S OFFICE
- ES - ELEVATOR STANDBY / STORAGE
- FO - FIRST OFFICER
- IC - INSPECTION CORRIDOR
- LAB - LABORATORY
- MN - DUTY NURSE
- MO - DOCTOR'S OFFICE
- MS - MEDICAL SUPPLIES
- OBS - OBSTETRICS
- OG - OBSERVATION GALLERY
- OR - OPERATING ROOM
- P - PORT (LEFT)
- PLS - PLACES
- PO - PSYCHIATRIST'S OFFICE
- PWT - PIPING / WIRING TRUNK
- S - STARBOARD (RIGHT)
- SO - SECURITY OFFICE
- ST - STORAGE
- TE - THEATER EQUIPMENT
- TL - TOILET
- WR - WAITING ROOM
- XE - TRANSPORTER EQUIPMENT
- XR - TRANSPORTER ROOM

PLAN SYMBOLS

- CHAIRS
- TABLES
- DINING TABLE
- SHOWER, TUB
- DRESSERS
- BED
- ROOM PARTITIONS
- White circular grille
- Red hexagonal grille
- LADDERS
- MATERIAL FABRICATION / RECLAMATION MACHINERY
- STAIRS, RAILING
- WALL and DOOR
- TRAPEZOIDAL ISOLATION DOORS
- TOILET, SINK
- MEDICAL DIAGNOSTIC BED
- CONTROL CONSOLES
- FOUNTAIN
- LAUNDRY UNIT
- CIRCUIT BREAKERS
- COMPUTERS
- WATER PRESSURE SYSTEM
- WATER PUMP MACHINERY
- HULL THICKNESS AT FLOOR LEVEL (Varies depending on hull curvature)
- TREE, SHRUB
- BATTERIES
- SANITARY WASTE RECOVERY SYSTEM
- AIR CONDITIONING EQUIPMENT

NOTES

This scrap-view shows the original layout with 14 decks and 8-foot (2.4 meter) ceilings. There were too many passenger accommodations (over 800) with this configuration. I show this here in case anyone wants to expand on the possibility of a troop transport, or a colonization ship, or an emergency evacuation variant, etc.

For the final design with 12 decks, the sizes of doors and turbo-elevators were not changed but the decks and the outer hull are a bit thicker. Keep in mind the position of the Hangar Bay and the Hangar Bay Doors have changed, as well as the location of the windows.

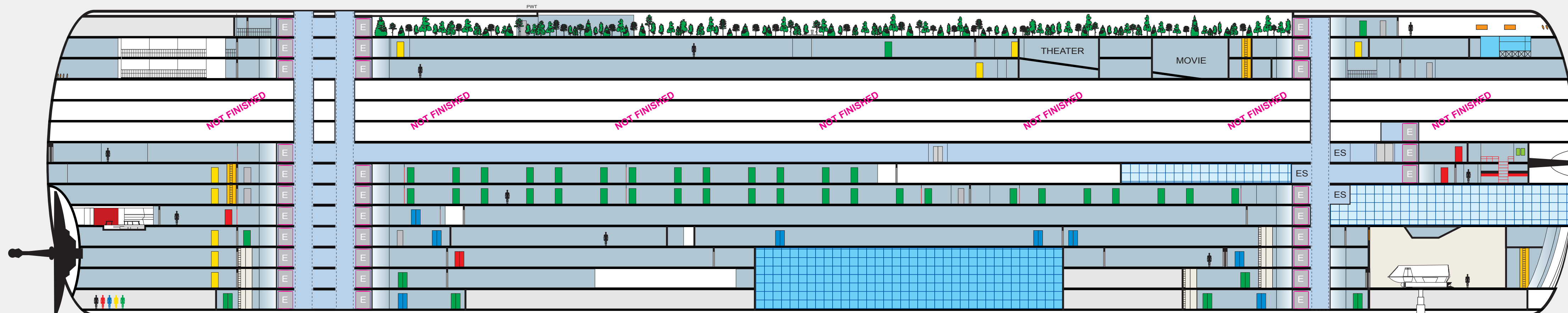

CUTAWAY