



NOTES

DECK 19

The Secondary Bridge is located at the front of this deck. Behind the Bridge is a turbo-elevator storage space. The Bridge is surrounded by computers. Outboard of the computers are two of the three rectangular protrusions that contain the Space Energy Field Sensors.

A Briefing Room is behind and to port of the Bridge and an Armory is behind and to starboard. A Phaser was stolen from the Armory on "H Deck" in THE CONSCIENCE OF THE KING. Since the Hangar Bay is located here, Deck 19 could be "H Deck". The Writer's Guide says the Hangar Bay is a "huge football field" sized area; this is simply not possible.

The Shuttlecraft shown here is 28 feet (8.5 meters) long. See comparison drawing and Note "S" on the Port Cutaway page for more info. In at least 2 episodes, the Hangar Bay is also called the Flight Deck.

Cargo Operations is not a full-time requirement, so there are walls that can be moved as needed. When there is no cargo being moved, this area is used for greeting dignitaries, or as a staging area for Landing Parties, or as a lounge / recreation area; equipment for these functions can be located in the cargo holds.

The oversized cargo doors encroach upwards into Deck 18 slightly.

DECK 20

Duplicate Officers' Quarters are located here and are sometimes used by officers even if the Secondary Hull has not separated from the Primary Hull. Using the alternate numbering system, Deck 20 becomes Deck 12; this explains why Mr. Spock took Mudd's women to the captain's quarters on Deck 12. Also, in THE ENEMY WITHIN, Kirk's alter-ego was seen near his quarters on Deck 12.

A large Food Preparation area and Messroom is located in the middle of this deck.

Aft of that is a continuation of the cargo processing area from the deck above.

The Shuttlecraft Maintenance High Bay is further aft but this is not accessible from Deck 20. It is halfway between Decks 20 and 21. The main entrances to the Shuttlecraft Maintenance area are at the top of a few steps leading up from Deck 21. However, this area can also be reached by climbing down the ladders from the port and starboard alcoves of the Hangar Bay on Deck 19. Those ladders drop onto the roof of port and starboard storage rooms within the Shuttlecraft Maintenance area.

At the extreme rear there is an aft Phaser Control room and an aft Phaser (specifically singular), as mentioned in ARENA. These can only be accessed by first entering the Shuttlecraft Maintenance area.

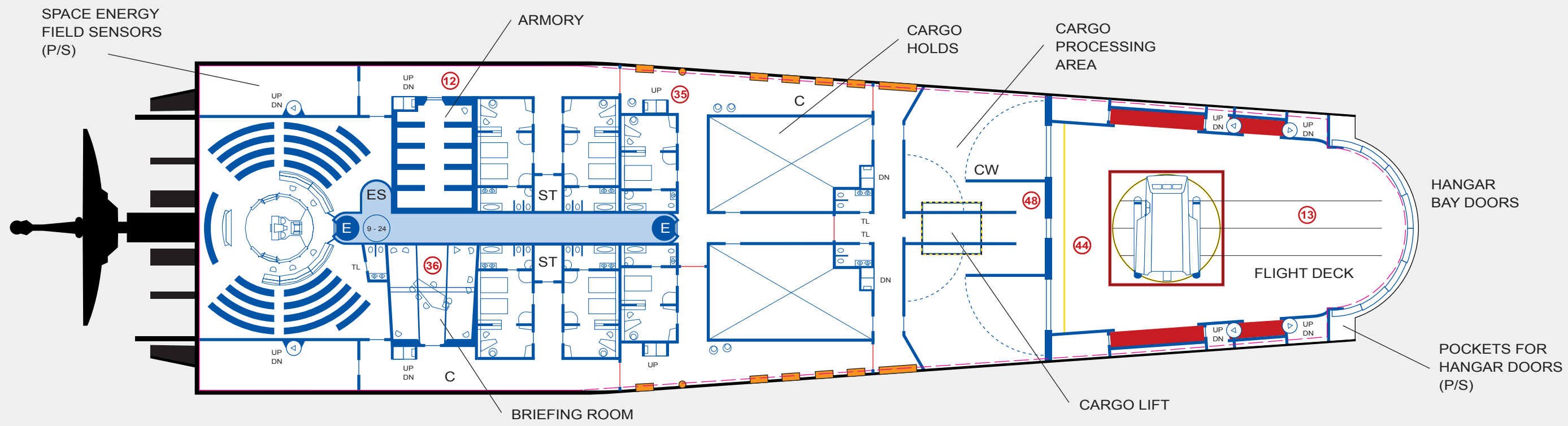

DECK 19 (H DECK): SECONDARY BRIDGE / HANGAR DECK DECK 11 (Secondary Hull)

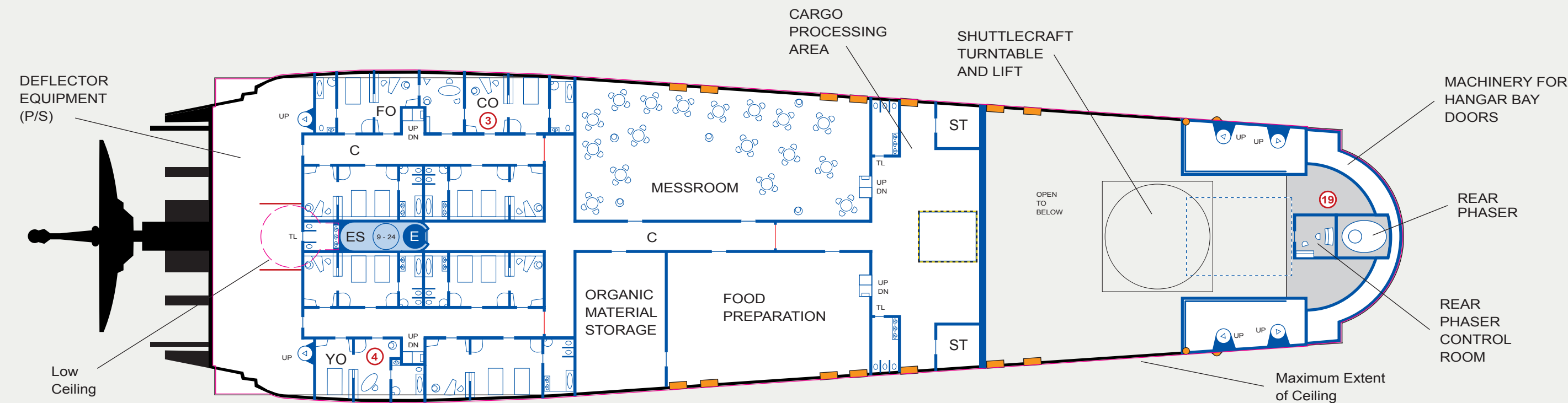

DECK 20: FOOD PREPARATION / SHUTTLE MAINTENANCE DECK 12 (Secondary Hull)